

11 Ashley Road Ryde, PO33 4AL

£105,000



OFFERED CHAIN FREE! With tenant-in-situ, this property is located on the outskirts of Ryde, however within short distance to mainland & local travel links. This terraced bungalow comprises living room, kitchen, bathroom, two bedrooms and conservatory. The seller is looking for a buyer without any chain ideally!

TERRACED BUNGALOW

2 BEDROOMS

SEMI-RURAL LOCATION

WATER SEWAGE COST INCLUDED

CONSERVATORY

# ROOMS

## Accommodation

**Living Room** 14' 5" x 11' 2" (4.4m x 3.4m) A good sized living room with access into the Kitchen and hallway, double glazing.

Electric heating. **Kitchen** 6' 7" x 5' 1" (2m x 1.55m) A compact kitchen which is forward facing with double glazing.

**Bedroom One** 10' 5" x 10' 2" (3.17m x 3.1m) A good sized double bedroom rear facing, double glazing. Electric heating.

**Bedroom Two** 9' 6" x 5' 11" (2.9m x 1.8m) A good sized single bedroom with sliding doors to the rear of the property which access the courtyard garden. Electric Heating.

**Bathroom** 6' 6" x 5' 9" (1.98m x 1.75m) A compact bathroom which has a shower over the bath, low level W/C and basin.

**Conservatory Outside:** Rear garden.

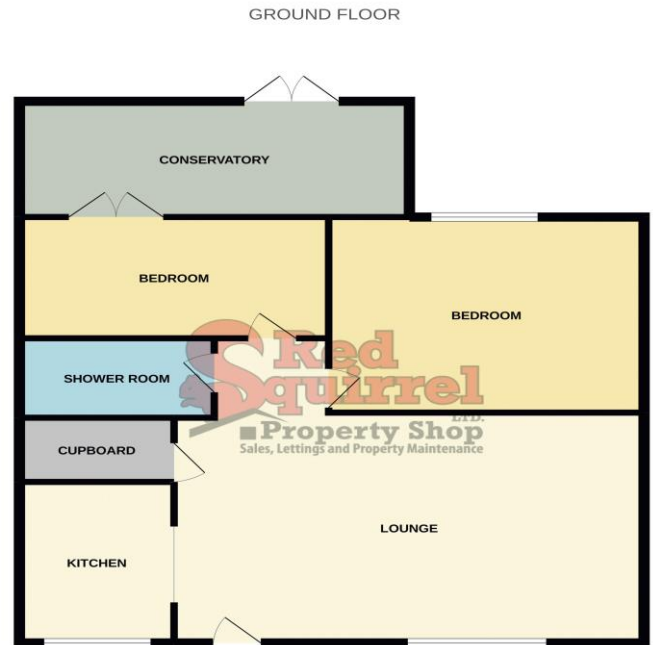

While every attempt has been made to ensure the accuracy of the floorplan contained here, measurements of doors, windows, rooms and any other items are approximate and no responsibility is taken for any error, omission or misstatement. The plan is for illustrative purposes only and should be used as a guide only by any prospective purchaser. The services, systems and appliances shown have not been tested and no guarantee as to their operation or efficiency can be given.  
Made with Metropix ©2022

Energy Efficiency Rating		
	Current	Potential
Very energy efficient - lower running costs		100
(92-100) <b>A</b>		
(81-91) <b>B</b>		
(69-80) <b>C</b>	80	
(55-68) <b>D</b>		
(39-54) <b>E</b>		
(21-38) <b>F</b>		
(1-20) <b>G</b>		
Not energy efficient - higher running costs		
<b>England, Scotland &amp; Wales</b>	EU Directive 2002/91/EC	